

## 15" x 36" Medicine Cabinet

- 15"W x 36"H x 4-5/8"D
- Available in Black and Brushed Nickel
- Featuring 1 flat glass mirror door and 3 interior adjustable tempered glass shelves
- Constructed of durable aluminum and mirrored glass
- Glass shelves are made from tempered safety glass
- Mirrors on back of doors and behind shelves
- Flexible orientation with the ability to rotate the unit so that the door swings open to the right or left
- Mounting hardware is included
- Coordinating metal side panels included for surface mounting
- Remove decorative side panels prior to recess mounting
- Coordinating metal interior
- For recess installations, mounting directly to the studs is recommended
- See installation guide for step by step instruction for surface or recess mounting

\*\*Please refer to the installation manual for cleaning instructions



Black Pictured Above

LUXART.

andressa®

# Urban Medicine Cabinet

LXMCURB1536

MMC1536

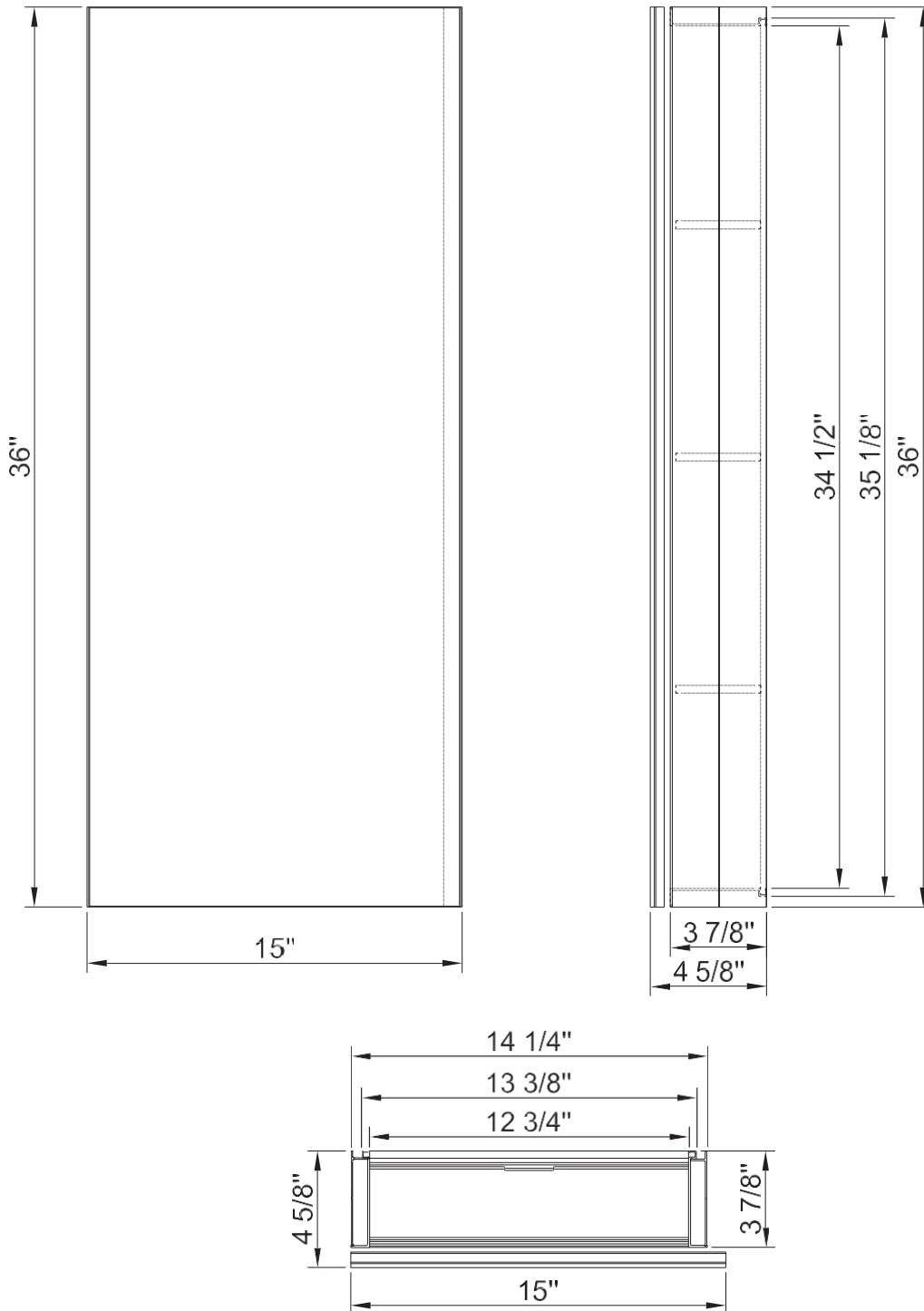

Need Help? If you have any questions or concerns, please email: [customerservice@luxartcollection.com](mailto:customerservice@luxartcollection.com).  
Por favor. Si tiene alguna pregunta o duda, envíe un correo electrónico: [customerservice@luxartcollection.com](mailto:customerservice@luxartcollection.com)